

model

60310

SINGLE - POINT PLATFORM LOAD CELL



FEATURES :

- ❖ Tool Steel Construction for Harsh Application
- ❖ Low Profile
- ❖ Single Point Capability with minimum error for off-centre loading
- ❖ Supports Platform Scale with size 600 x 600 (mm)
- ❖ Compact, Light Weight & Economical

APPLICATIONS :

- ❖ Smaller Sized Economical Platform Scales
- ❖ Check Weighers
- ❖ Bag Weighers

DESCRIPTION :

This is a strain Gage based low profile bending beam Load Cell for platform size of 600 x 600 (mm). It is an economical cell for smaller size low profile platform scales. It is off center load compensated and is rugged to take shock loads.

PERFORMANCE SPECIFICATION :

Standard Capacities (Kgf.)	: 75, 100, 120, 150, 200, 250, 300, 400
Excitation Voltage	: 10 VDC - Maximum 15 VDC
Nominal Output	: 2.0 mV/V
Non - Linearity	: < ± 0.025 % FSO (Full Scale Output)
Hysteresis	: < ± 0.01 % FSO
Non - Repeatability	: < ± 0.02 % FSO
Creep (30 minutes)	: < ± 0.03 % FSO
Zero Balance	: ± 1.0 % FSO
Input resistance	: 390 ± 15 Ohms
Output Resistance	: 350 ± 5 Ohms
Insulation Resistance	: > 1000 Mega Ohms
Safe Overload	: 150% of Rated Capacity
Ultimate Overload	: 250 % of Rated Capacity
Temperature	: 0-60° C
Compensated Range	
Temperature Effect on Output	: < 0.0015 % FSO/° C
Temperature Effect on Zero	: < 0.0020 % FSO/° C
Platter Size	: 600 x 600 mm
Eccentric Load Effect	: < 0.02% of FSO at 1/3 rated load placed within 300mm radius from the center of Load Cell
Deflection	: < 0.5 mm at FSO
Tightening Torque	: 5 m. kg.
Finish & Construction	: Electroless Nickel plated Tool Steel
Environmental Protection Class	: IP65



ADI ARTECH
TRANSDUCERS PVT. LTD.

A Joint venture with
ARTECH INDUSTRIES INC., U.S.A.

ELECTRICAL TERMINATION

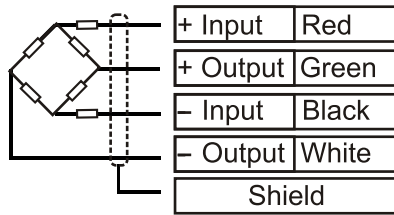

4 CORE SCREENED CABLE - 3 mtrs.

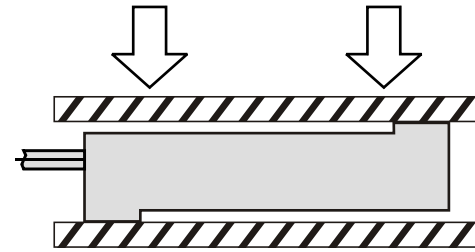

M8 X 16 DEEP (9 PLACES)

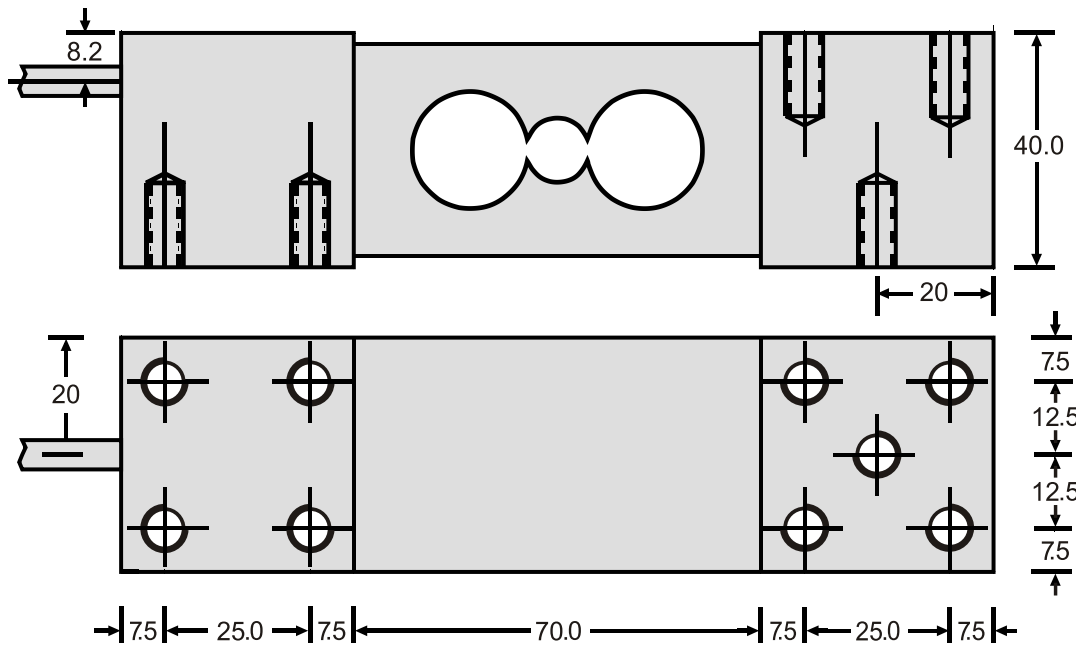

ARROW SHOWS LOAD DIRECTION FOR +VE OUTPUT



TOP VIEW

All dimensions are in mm.

ORDER INFORMATION :

ADI ARTECH is dedicated in maintaining adequate inventories of its Load Cells to provide the best service in the industry.

Order by the model number and indicate the capacity required.

Specifications are subject to change without notice

	Manufactured by :	917/1, G.I.D.C. ESTATE, MAKARPURA, VADODARA - 390 010 (INDIA)
	ADI ARTECH	Phone : 2655083/2651023
	TRANSDUCERS PVT. LTD.	FAX : (91) 0265-2638751
	A Joint venture with ARTECH INDUSTRIES INC., U.S.A.	E-mail : sales@adiartech.com artechad1@sancharnet.in
		Website : www.adiartech.com

QUALITY * PERFORMANCE * SERVICE
“A PREFERRED NAME IN LOAD CELL TECHNOLOGY”