

Description

The WM-IX - Weighing Module is designed to utilize 20310 / 20410 / 20410-FLAT Load Cells for handling hanging loads in crane , material handling systems in ware houses and ship yards. It is also utilized in inline force measurements. Its dimensions are to fit to our above load cells.

Features

- 2Tf to 120 Tf.
- Alloy steel grade 6 / 8 construction.

Applications

- Hanging Load Weighing.
- Line Tension Measurement.



Grade	D	W	e	L	Load Limit-Tf.	Self Wt. Kg.
6	16	20.6	30	48	2	0.33
6	22.4	31.8	46	72	4.75	1.1
6	35.1	51.5	76	119	12	43
6	41.4	60.5	92	146	17	7.8
8	41.4	60.5	92	146	30	8.5
8	57.2	82.6	122	194	55	24
8	69.9	105	148	267	85	44
8	82.6	127	165	330	120	81

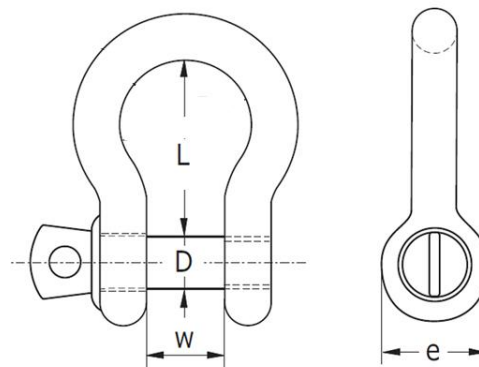

Specifications are subject to change without notice.

All dimensions are in mm.

	<p>Made in INDIA by:</p> <p>ADI ARTECH</p> <p>TRANSDUCERS PVT. LTD.</p> <p>A Joint venture with ARTECH INDUSTRIES INC., U.S.A</p>	<p>917/1, G.I.D.C. Estate, Makarpura, Vadodara - 390 010, Gujarat, INDIA</p> <p>Mobile : +91-9374068998, 9879444551, 9054467370</p> <p>Email : sales@adiartech.com, adiartech@adiartech.com</p> <p>Website : www.adiartech.com</p>
--	---	---